

COVINGTON
12615 Cumberland Crest Drive
Huntersville, NC 28078

3BR, 2BA, Fenced Yard
Fireplace, 2 Car Garage

One month refundable security deposit

Directions: I77 to exit 23 east on Gilead towards town. Cross railroad tracks, continue to L into Covington subdivision, L Cumberland Crest

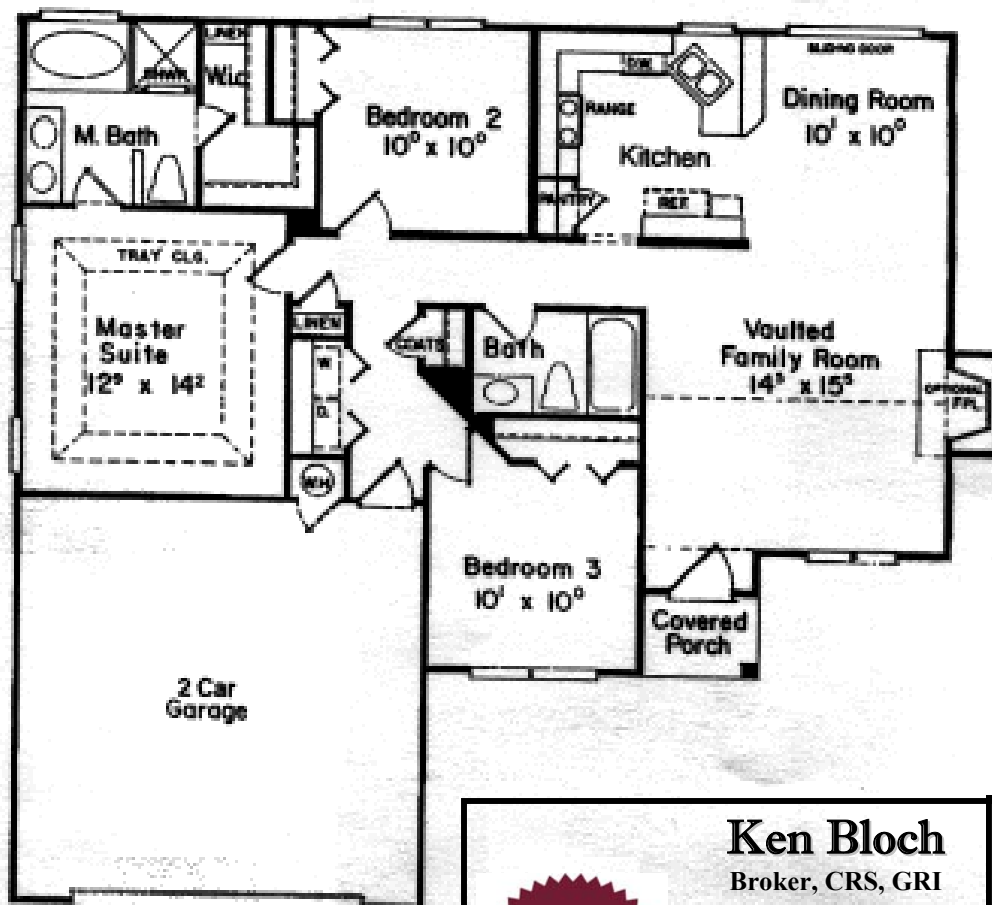

Ken Bloch
Broker, CRS, GRI
704-502-3290
888-291-9957
KenBloch@msn.com
www.KenBloch.com

19460 Old Jetton Road
Cornelius, NC 28031

